

Bio3 IMPLANTS

Premium Dental Implants



SUPRASTRUCTURES

Bio3 IMPLANTS

 Premium Dental Implants



Bio3 IMPLANTS COMPANY



CONTENT

Premium Tapered Implants Range

Bio3 IMPLANTS

Bio3 Implants is the synergy of the best achievements of the German dentistry school and innovative global developments.

Bio3 Implants GmbH is a German company, which offers dentists best solutions of the highest quality and accuracy in implantology. We develop, produce and implement reliable and quality implant systems of premium line.

Bio3 Implants team tends to make implantation simple, easy, high-quality and highly gentle for the patient. To achieve this goal the company develops innovative premium quality products as well as provides its customers with a high standard service.

Reliability and quality

Bio3 Implants conducts continuous and systematic quality control of all products which is confirmed by international quality standards ISO13485:2016, CE2797.

During the past years the company extended its production with the most advanced high-tech equipment. Technological cycle of Bio3 Implants production is ensured by high standards of German quality. All products go through numerous stages of quality control.

Identification and warranty

Each Bio3 Implants product is assigned with a unique serial number that allows to track the history of the product manufacturing from the first to the final stage. Bio3 Implants provides a lifetime warranty on all its products. Each implant includes Warranty Card, Product certificate and a manual for the patient.

Compactness and availability

We offer a simple and reliable solution for all possible clinical situations. The doctors use only one surgical kit to perform operations on all implant types. Bio3 implant system has 2 platforms for implants with conical connection and internal hexagon fixation for absolute stability.



Suprastructures

- 02 Gingiva Healing Abutments
- 05 Straight Anatomic Abutments
- 05 Plastic transfer cap
- 06 Straight Abutments
- 07 Angled Abutments 15°
- 08 Angled Abutments 25°
- 09 Impression Suprastructures
- 10 Straight Multi-Units
- 11 Angled Multi-Units 17°
- 12 Angled Multi-Units 30°
- 13 Ball Attachments
- 14 Locators
- 15 Burn-out Abutments
- 16 Titanium Base for CAD/CAM
- 17 Prosthetics for CAD/CAM

GINGIVA HEALING ABUTMENTS

Standard platform

INTERNAL HEX

2.1

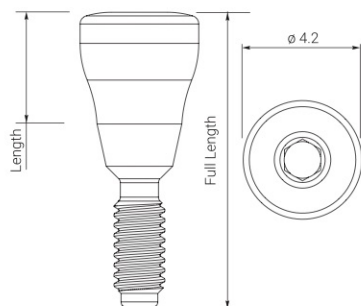

PRODUCT CODE

STANDARD



HEALING CAPS

MATERIAL Titanium Grade 5

DIAMETER	4.2 mm	4.2 mm	4.2 mm	4.2 mm	4.2 mm
LENGTH	2 mm	3 mm	4 mm	5 mm	7 mm
FULL LENGTH	8.45 mm	9.45 mm	10.45 mm	11.45 mm	13.45 mm

Healing cap for standard platform (2.1 mm) with two diameters – 4.2 mm and 5.5 mm. It is installed using universal or hand prosthetic insertion driver.

WIDE



PRODUCT CODE

DIAMETER	5.5 mm	5.5 mm	5.5 mm	5.5 mm
LENGTH	2 mm	3 mm	4 mm	5 mm
FULL LENGTH	7.72 mm	8.73 mm	9.73 mm	10.73 mm

MATERIAL Titanium Grade 5

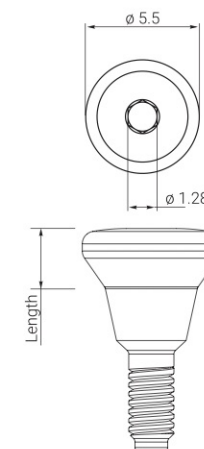

GINGIVA HEALING ABUTMENTS

Wide platform

INTERNAL HEX

2.5

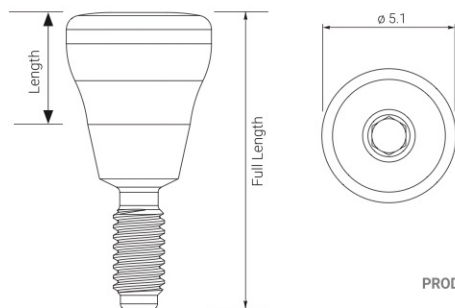

PRODUCT CODE

STANDARD



HEALING CAPS

MATERIAL Titanium Grade 5

DIAMETER	5.1 mm	5.1 mm	5.1 mm	5.1 mm	5.1 mm
LENGTH	2 mm	3 mm	4 mm	5 mm	7 mm
FULL LENGTH	8.45 mm	9.45 mm	10.45 mm	11.45 mm	13.45 mm

Healing cap for wide platform (2.5 mm) with two diameters – 5.1 mm and 5.5 mm.

It is installed using universal or hand prosthetic insertion driver.

WIDE



PRODUCT CODE

MATERIAL Titanium Grade 5

DIAMETER	5.5 mm	5.5 mm	5.5 mm	5.5 mm
LENGTH	2 mm	3 mm	4 mm	5 mm
FULL LENGTH	7.9 mm	8.9 mm	9.9 mm	10.9 mm

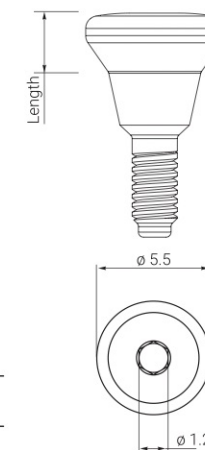

GINGIVA HEALING NARROW ABUTMENTS

Standard platform

INTERNAL HEX

2.1

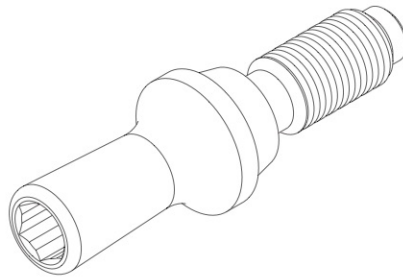

MATERIAL Titanium Grade 5

DIAMETER 3.2 mm
LENGTH 10.5 mm



PRODUCT CODE **GFNS**

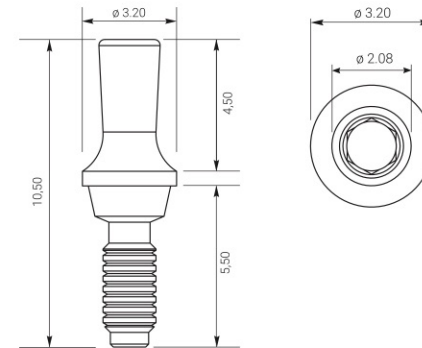

Wide platform

INTERNAL HEX

2.5

Ensures ideal gingival margin.
Suitable for any variants
of the following dental
prosthetics

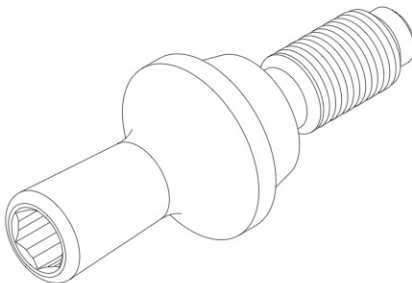

MATERIAL Titanium Grade 5

DIAMETER 4.0 mm
LENGTH 10.5 mm



PRODUCT CODE **GFNB**

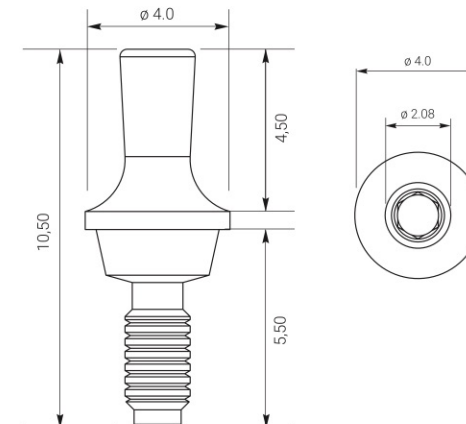

STRAIGHT ANATOMIC ABUTMENTS

Standard platform

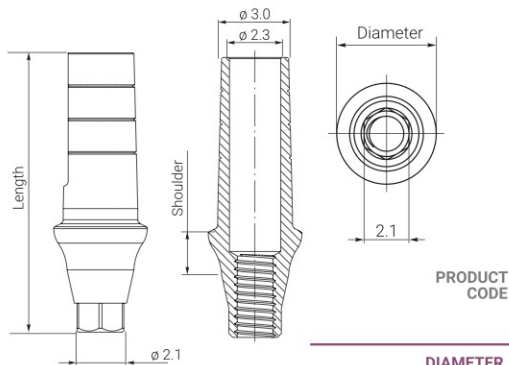

PRODUCT CODE

STANDARD



GAAS1

GAAS2

GAAS3

DIAMETER	4.2 mm	4.2 mm	4.2 mm
SHOULDER	1 mm	2 mm	3 mm
LENGTH	11.55 mm	12.55 mm	13.55 mm

WIDE



GAAS/W-1

GAAS/W-2

GAAS/W-3

DIAMETER	5.5 mm	5.5 mm	5.5 mm
SHOULDER	1 mm	2 mm	3 mm
LENGTH	11.55 mm	12.55 mm	13.55 mm

INTERNAL HEX

2.1

Each abutment set includes:



PROSTHETIC SCREW SS*

MATERIAL Titanium Grade 5

Anatomic titanium abutment for standard platform (2.1 mm) with 1. 2. 3 mm shoulders that has two shoulder diameter widths – 4.2 mm and 5.5 mm. It is installed using universal or hand prosthetic insertion driver.

Wide platform

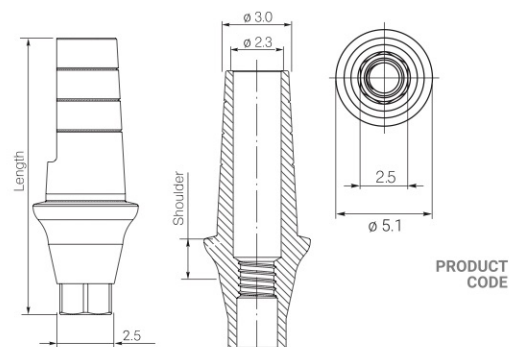

PRODUCT CODE



GAAB1

GAAB2

GAAB3

DIAMETER	5.1 mm	5.1 mm	5.1 mm
SHOULDER	1 mm	2 mm	3 mm
LENGTH	12.4 mm	13.4 mm	14.4 mm

MATERIAL Titanium Grade 5

Anatomic titanium abutment for wide platform (2.5 mm) with 1. 2. 3 mm shoulders. It is installed using universal or hand prosthetic insertion driver.

INTERNAL HEX
2.5

Each abutment set includes:



PROSTHETIC SCREW SW*

PLASTIC TRANSFER CAP

STANDARD PLATFORM

WIDE PLATFORM

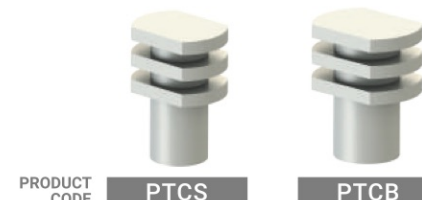

PRODUCT CODE

PTCS

PTCB

DIAMETER	7.0 mm	8.0 mm
LENGTH	10 mm	10 mm

STRAIGHT ABUTMENTS

Standard platform

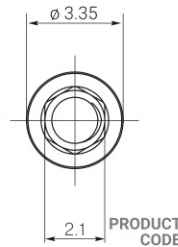
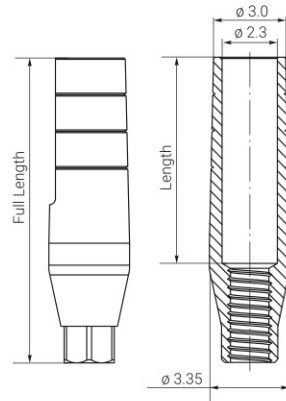

WIDE



GABS9

STANDARD



GAS8



GAS9



GAS13

DIAMETER	5.0 mm	3.35 mm	3.35 mm	3.35 mm
LENGTH	9 mm	6.7 mm	8.7 mm	11.7 mm
FULL LENGTH	13.7 mm	10.55 mm	12.55 mm	15.55 mm

MATERIAL Titanium Grade 5

Titanium straight abutment for standard platform (2.1 mm). It is installed using universal or hand prosthetic insertion driver.

INTERNAL HEX

2.1

Each abutment set includes:



PROSTHETIC SCREW SS*

Wide platform

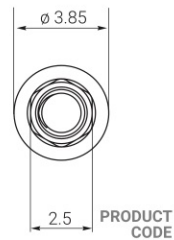
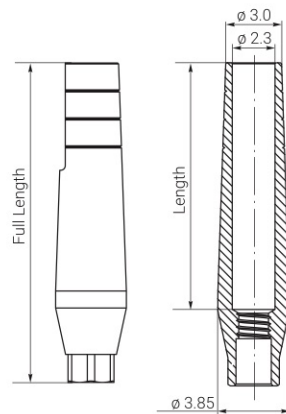

WIDE



GABB9

STANDARD

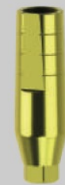

GAB8

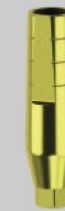

GAB9



GAB13

DIAMETER	5.5 mm	3.85 mm	3.85 mm	3.85 mm
LENGTH	9 mm	8.07 mm	10.07 mm	13.07 mm
FULL LENGTH	13.9 mm	12.12 mm	14.12 mm	17.12 mm

MATERIAL Titanium Grade 5

Titanium straight abutment for wide platform (2.5 mm). It is installed using universal or hand prosthetic insertion driver.

INTERNAL HEX

2.5

Each abutment set includes:



PROSTHETIC SCREW SW*

ANGLED ABUTMENTS 15°

Standard platform

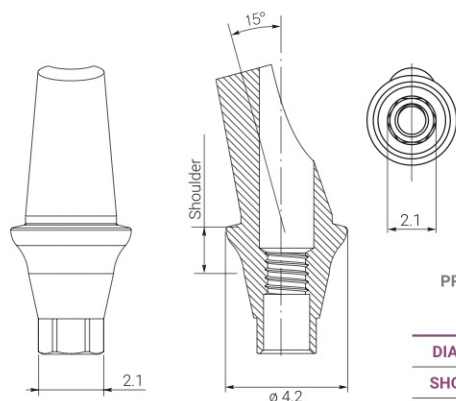

PRODUCT
CODE



DIAMETER	3.35 mm	4.2 mm	4.2 mm	4.2 mm
SHOULDER		1 mm	2 mm	3 mm
LENGTH	11.0 mm	10.85 mm	11.85 mm	12.85 mm
ANGLE	15°	15°	15°	15°

MATERIAL Titanium Grade 5

Angled anatomic titanium abutment 15° for standard platform (2.1 mm) with 1. 2. 3 mm shoulder or without it. It is installed using universal or hand prosthetic insertion driver.

INTERNAL HEX
2.1

Each abutment set includes:



PROSTHETIC SCREW **SS***

Wide platform

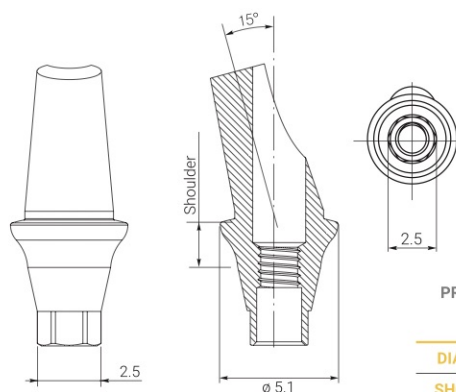

PRODUCT
CODE



DIAMETER	3.85 mm	5.1 mm	5.1 mm	5.1 mm
SHOULDER		1 mm	2 mm	3 mm
LENGTH	12.85 mm	11.55 mm	12.2 mm	13.2 mm
ANGLE	15°	15°	15°	15°

MATERIAL Titanium Grade 5

Angled anatomic titanium abutment 15° for wide platform (2.5 mm) with 1. 2. 3 mm shoulder or without it. It is installed using universal or hand prosthetic insertion driver.

INTERNAL HEX
2.5

Each abutment set includes:



PROSTHETIC SCREW **SW***

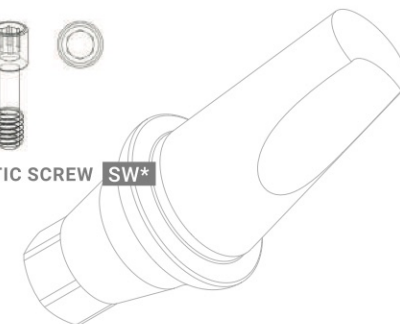

ANGLED ABUTMENTS 25°

Standard platform

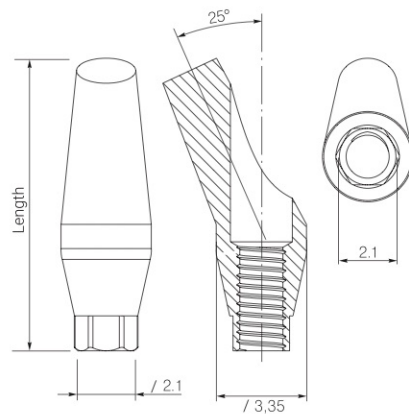

PRODUCT CODE

DIAMETER	3.35 mm	4.2 mm
SHOULDER		2 mm
LENGTH	10.9 mm	11.75 mm
ANGLE	25°	25°

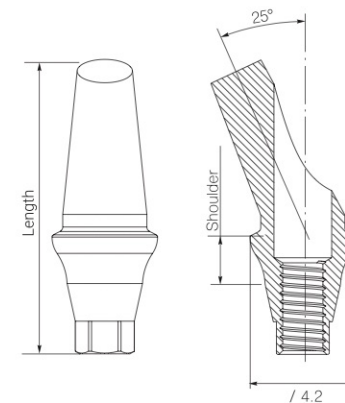

INTERNAL HEX
2.1

Each abutment set includes:



PROSTHETIC SCREW SS*

MATERIAL Titanium Grade 5

Angled anatomic titanium abutment 25° for standard platform (2.1 mm) with 2 mm shoulder or without it. It is installed using universal or hand prosthetic insertion driver.

Wide platform

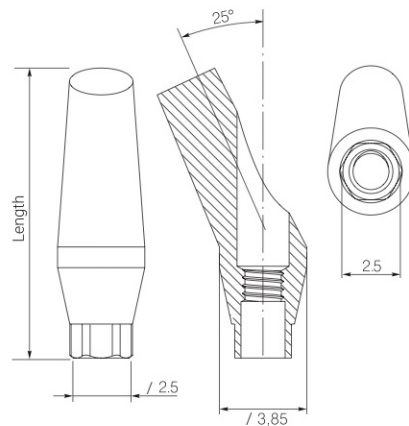

PRODUCT CODE

DIAMETER	3.85 mm	5.1 mm
SHOULDER		2 mm
LENGTH	12.8 mm	12.15 mm
ANGLE	25°	25°

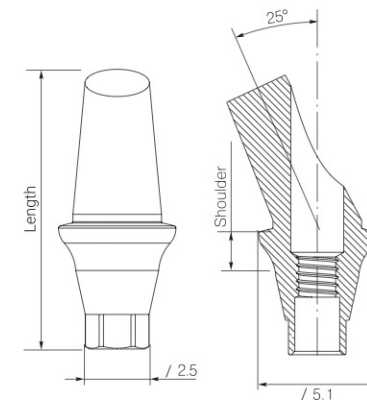

INTERNAL HEX
2.5

Each abutment set includes:



PROSTHETIC SCREW SW*

MATERIAL Titanium Grade 5

Angled anatomic titanium abutment 25° for wide platform (2.5 mm) with 2 mm shoulder or without it. It is installed using universal or hand prosthetic insertion driver.

IMPRESSION SUPRASTRUCTURES

Impression transfers for open tray

STANDARD PLATFORM		WIDE PLATFORM		
3.75 mm	4 mm			DIAMETER
12.3 mm	13.5 mm			LENGTH

Each transfer set includes:

PRODUCT CODE **SOLS11** **SOLB11**

MATERIAL Titanium Grade 5

SCREW **SFT22**

Laboratory analogs

STANDARD PLATFORM		WIDE PLATFORM		
3.75 mm	4 mm			DIAMETER
12.3 mm	13.5 mm			LENGTH

Each transfer set includes:

PRODUCT CODE **IAS** **IAB**

MATERIAL Titanium Grade 5

STANDARD PLATFORM		WIDE PLATFORM		
4.2 mm	5.1 mm			DIAMETER
17.85 mm	18.45 mm			LENGTH

Each transfer set includes:

PRODUCT CODE **SOLS15** **SOLB15**

MATERIAL Titanium Grade 5

SCREW **SFT22**

Impression transfers for closed tray

STANDARD PLATFORM		WIDE PLATFORM		
4.2 mm	5.1 mm			DIAMETER
13.75 mm	14.35 mm			LENGTH

Each transfer set includes:

PRODUCT CODE **SGLS9** **SGLB9**

MATERIAL Titanium Grade 5

SCREW **SFT17**

STRAIGHT MULTI-UNITS

Antirotational Aesthetic Abutment S+ /W+

Standard platform

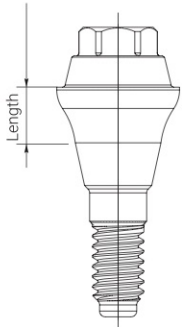

MATERIAL Titanium Grade 5

PRODUCT
CODE

VAAS1+

VAAS2+

VAAS3+

DIAMETER	4.3 mm	4.3 mm	4.3 mm
LENGTH	1 mm	2 mm	3 mm

The abutment is used to restore a fixed bridge with screw retention.
Screw in with a maximum force of 20 newton.

INTERNAL HEX
2.1

Wrench for MU



WF-MU
mandatory position
for using

For SINGLE construction

Titanium sleeve for screw
retained abutment

Base for Out-Burnt
Abutment Hex



Wide platform

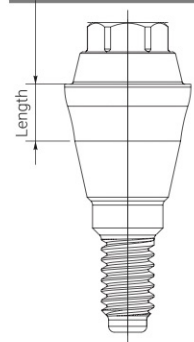

MATERIAL Titanium Grade 5

PRODUCT
CODE

VAAB1+

VAAB2+

VAAB3+

DIAMETER	4.3 mm	4.3 mm	4.3 mm
LENGTH	1 mm	2 mm	3 mm

INTERNAL HEX
2.5

Wrench for MU



WF-MU
mandatory position
for using

Burnout plastic sleeve

Transfer

Temporary PEEK sleeve



For FIXED BRIDGE construction

Titanium sleeve

Castable sleeve

Healing Cap

Healing Cap Wide

Burnout plastic sleeve

Temporary PEEK sleeve

Laboratory Analog

Transfer



* Screw for Gima is included

ANGLED MULTI-UNIT 17°

Titanium basis for multi-unit S/W

Standard platform

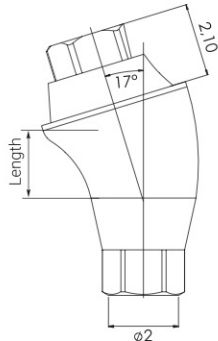

PRODUCT CODE

TBMS1701

TBMS1702

TBMS1703

DIAMETER	4.35 mm	4.35 mm	4.35 mm
LENGTH	1 mm	2 mm	3 mm

Angled multi-unit 17° of a standard/wide platform is intended for the construction with screw retention during the treatment of partial or full adentia. It is used in cases where the implant is placed at an angle. A multifunctional torque wrench is used for the installation.

INTERNAL HEX
2.1

Each multi-unit basis set includes:



Screw for Multiunit Base SMB

For SINGLE construction

Titanium sleeve for screw retained abutment



GAVAA

Base for Out-Burnt Abutment Hex



CSMU-H

Wide platform

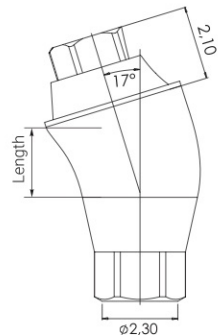

PRODUCT CODE

TBMB1701

TBMB1702

TBMB1703

DIAMETER	4.35 mm	4.35 mm	4.35 mm
LENGTH	1 mm	2 mm	3 mm

INTERNAL HEX
2.5

Each multi-unit basis set includes:



Screw for Multiunit Base SMB

Burnout plastic sleeve



Plastic VAAS

Temporary PEEK sleeve



TGAS1

For FIXED BRIDGE construction

Titanium sleeve



GIMV

Castable sleeve



CSMU

Healing Cap



GIMA

Healing Cap Wide



GIMA-W

Burnout plastic sleeve



Plastic TCMS

Temporary PEEK sleeve



TGMN 1

Laboratory Analog



IAEN

Transfer



SOKM15

ANGLED MULTI-UNIT 30°

Titanium basis for multi-unit S/W

Standard platform

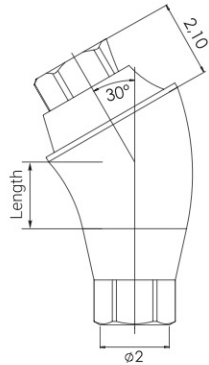

PRODUCT
CODE

TBMS3001

TBMS3002

TBMS3003

DIAMETER

4.3 mm

4.3 mm

4.3 mm

LENGTH

1 mm

2 mm

3 mm

INTERNAL HEX
2.1

Each multi-unit basis set
includes:



Screw for
Multiunit Base **SMB**

For SINGLE construction

Titanium sleeve for screw
retained abutment



GAVAA

Base for Out-Burnt
Abutment Hex



CSMU-H

Burnout plastic sleeve



Plastic VAAS

Temporary PEEK sleeve



TGAS1

Wide platform

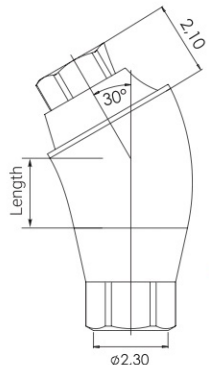

PRODUCT
CODE

TBMB3001

TBMB3002

TBMB3003

DIAMETER

4.3 mm

4.3 mm

4.3 mm

LENGTH

1 mm

2 mm

3 mm

INTERNAL HEX
2.5

Each multi-unit basis set
includes:



Screw for
Multiunit Base **SMB**

Angled multi-unit 30° of a standard/wide platform is intended for the construction with screw retention during the treatment of partial or full adentia. It is used in cases when the implant is placed at an angle. A multifunctional torque wrench is used for the installation.

For FIXED BRIDGE construction

Titanium sleeve



GIMV

Castable sleeve



CSMU

Healing Cap



GIMA

Healing Cap Wide



GIMA-W

Burnout plastic sleeve



Plastic TCMS

Temporary PEEK sleeve



TGMN 1

Laboratory Analog



IAEN

Transfer



SOKM15

* Screw for Gima is included

BALL ATTACHMENTS

Standard platform

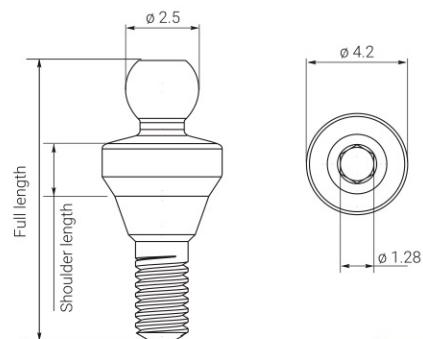

MATERIAL Titanium Grade 5

PRODUCT
CODE



DIAMETER	4.2 mm	4.2 mm	4.2 mm	4.2 mm	4.2 mm
SHOULDER LENGTH	2 mm	3 mm	4 mm	5 mm	6 mm
FULL LENGTH	9,95 mm	10,95 mm	11,95 mm	12,95 mm	13,95 mm

Ball attachment for overdentures and removable dentures fixation for standard platform (2.1 mm) as an element for dental prosthetics on two or more implants.
It is installed using universal or hand prosthetic insertion driver.

Wide platform

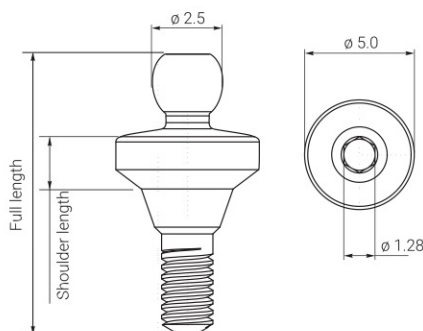

MATERIAL Titanium Grade 5

PRODUCT
CODE



DIAMETER	5.0 mm	5.0 mm	5.0 mm	5.0 mm	5.0 mm
SHOULDER LENGTH	2 mm	3 mm	4 mm	5 mm	6 mm
FULL LENGTH	10,6 mm	11,6 mm	12,6 mm	13,6 mm	14,6 mm

Ball attachment for overdentures and removable dentures fixation for wide platform (2.5 mm) as an element for dental prosthetics on two or more implants.
It is installed using universal or hand prosthetic insertion driver.

INTERNAL HEX

2.1

Each ball attachment should be supported by metal cap with 3 caps applied in the following sequence:
Metal ← Soft ← Standard ← Hard to ensure the most comfortable adaptation of the patient to his new dental prosthesis.

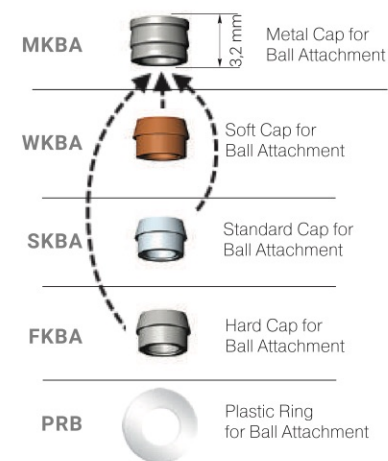

INTERNAL HEX

2.5



LOCATORS

Standard platform

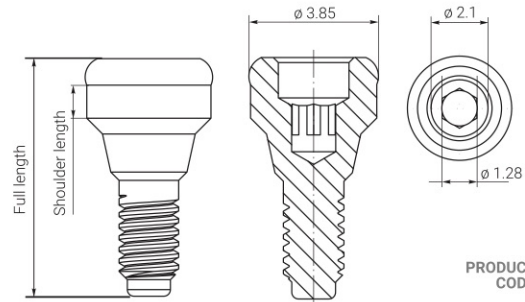

MATERIAL Titanium Grade 5

DIAMETER	3.85 mm	3.85 mm	3.85 mm	3.85 mm	3.85 mm
SHOULDER LENGTH	2 mm	3 mm	4 mm	5 mm	6 mm
FULL LENGTH	8,2 mm	9,2 mm	10,2 mm	11,2 mm	12,2mm

Locators for overdentures and removable dentures fixation for standard platform (2.1 mm) as an element for dental prosthetics on two or more implants. It is installed using universal or hand prosthetic insertion driver.

Wide platform

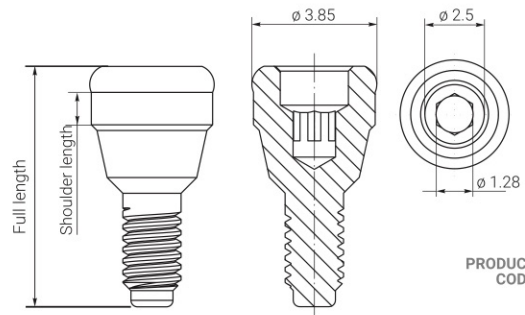

MATERIAL Titanium Grade 5

DIAMETER	3.85 mm	3.85 mm	3.85 mm	3.85 mm	3.85 mm
SHOULDER LENGTH	2 mm	3 mm	4 mm	5 mm	6 mm
FULL LENGTH	8,2 mm	9,2 mm	10,2 mm	11,2 mm	12,2 mm

Locators for overdentures and removable dentures fixation for wide platform (2.5 mm) as an element for dental prosthetics on two or more implants. It is installed using universal or hand prosthetic insertion driver.

INTERNAL HEX
2.1

Each ball attachment should be supported by metal cap with 3 applied in the following sequence: Metal ← Soft ← Standard ← Hard to ensure the most comfortable adaptation of the patient to his new dental prosthesis.

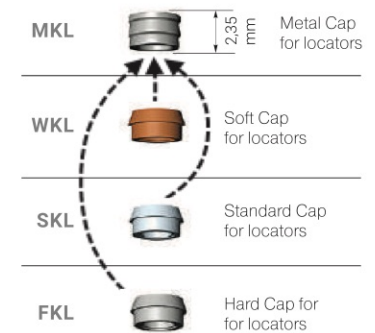

INTERNAL HEX
2.5

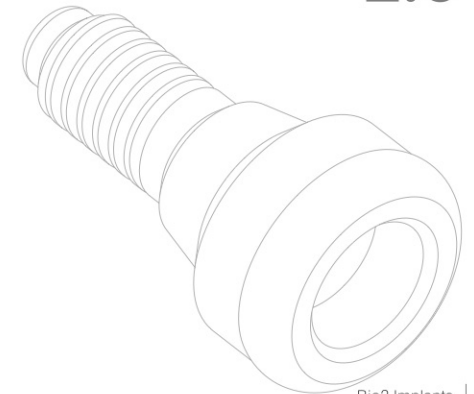

BURNOUT PLASTIC SLEEVE ABUTMENTS

Standard platform

INTERNAL HEX

2.1

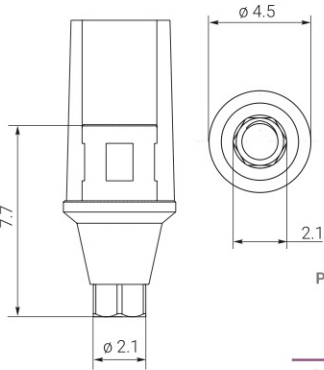

PRODUCT CODE

TBKS1

Each abutment set includes:



PROSTHETIC SCREW **SS***

DIAMETER	4.5 mm
LENGTH	7.7 mm

MATERIAL Cobalt-chrome

Wide platform

INTERNAL HEX

2.5

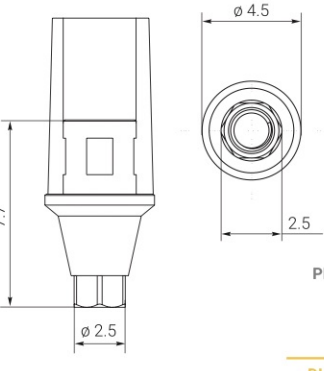

PRODUCT CODE

TBKB1

Each abutment set includes:



PROSTHETIC SCREW **SW***

DIAMETER	4.5 mm
LENGTH	7.7 mm

MATERIAL Cobalt-chrome

BURNOUT ABUTMENTS

Standard platform

For bridge construction

DIAMETER 4.2 mm

LENGTH 14 mm

Plastic Cylinder Abutment Non Hex

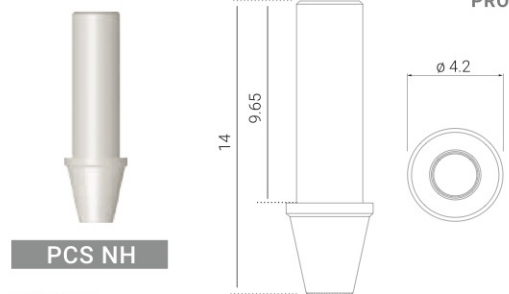

PCS NH

MATERIAL Burned out plastic

Each platform set includes:



PROSTHETIC SCREW **SS***

Wide platform

For bridge construction

DIAMETER 4.6 mm

LENGTH 14.5 mm

Plastic Cylinder Abutment Non Hex

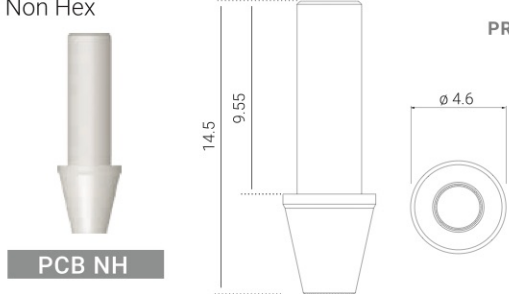

PCB NH

MATERIAL Burnout plastic

Each platform set includes:



PROSTHETIC SCREW **SW***

PROSTHETICS FOR CAD/CAM

Standard platform

Ti Base S for CEREC

DIAMETER	5.0 mm
FUNCTIONAL LENGTH	4.65 mm
SHOULDER	1 mm

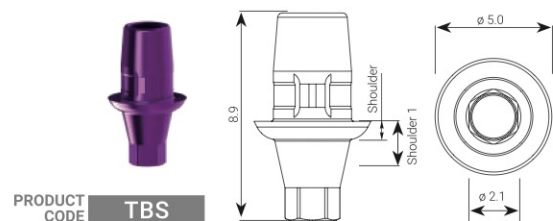

MATERIAL
Titanium Grade 5

Titanium platform for CAD/CAM

	Non Hex				
PRODUCT CODE	TPS-NH	TPS	TPS1	TPS2	TPS3
DIAMETER	4.6 mm	4.6 mm	4.6 mm	4.6 mm	4.6 mm
FUNCTIONAL LENGTH	4.1 mm	4.1 mm	4.1 mm	4.1 mm	4.1 mm
SHOULDER	0.5 mm	0.5 mm	1 mm	2 mm	3 mm
SHOULDER 1	1.3 mm	1.3 mm	2.3 mm	3.3 mm	4.3 mm

MATERIAL
Titanium Grade 5

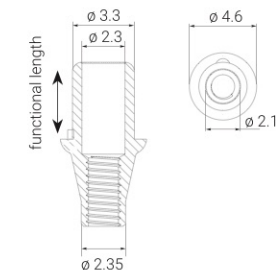

Each platform set includes:



PROSTHETIC SCREW SS*

Wide platform

Ti Base W for CEREC

DIAMETER	5.0 mm
FUNCTIONAL LENGTH	4.65 mm
SHOULDER	1 mm

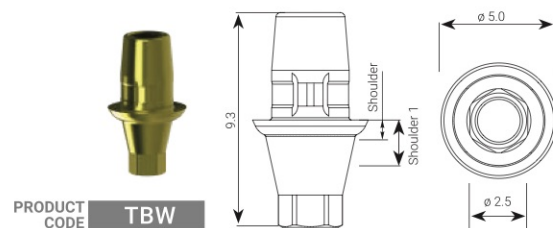

MATERIAL
Titanium Grade 5

Titanium platform for CAD/CAM

	Non Hex				
PRODUCT CODE	TPB-NH	TPB	TPB1	TPB2	TPB3
DIAMETER	5.1 mm	5.1 mm	5.1 mm	5.1 mm	5.1 mm
FUNCTIONAL LENGTH	4.05 mm	4.1 mm	4.1 mm	4.1 mm	4.1 mm
SHOULDER	0.5 mm	0.5 mm	1 mm	2 mm	3 mm
SHOULDER 1	1.3 mm	1.3 mm	2.3 mm	3.3 mm	4.3 mm

MATERIAL
Titanium Grade 5

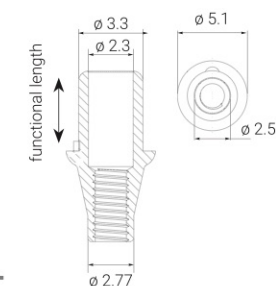

Each platform set includes:



PROSTHETIC SCREW SW*

PROSTHETICS FOR CAD/CAM

Standard platform

PREMILL ABUTMENT

for Arum

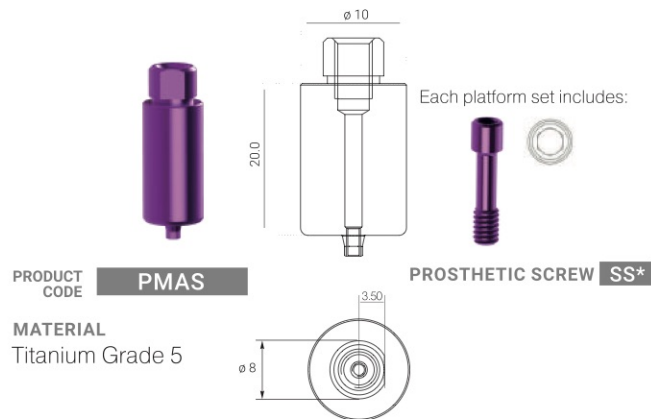

TITANIUM SCAN- ABUTMENT

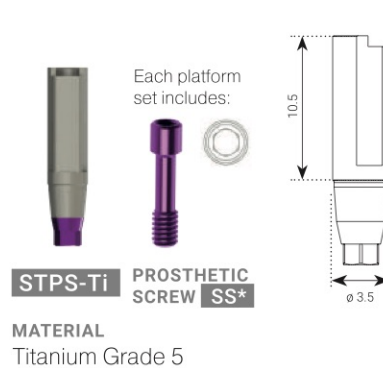

Wide platform

PREMILL ABUTMENT

for Arum

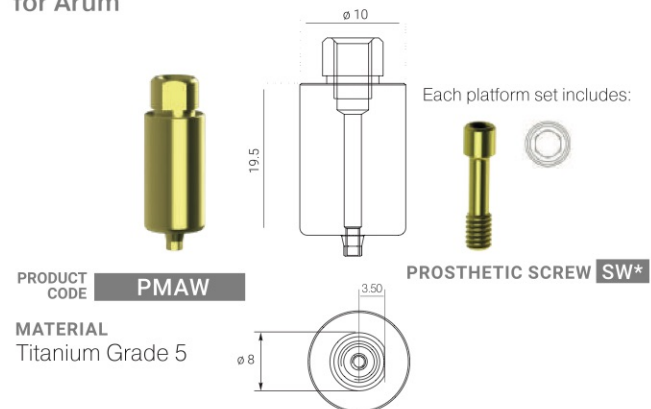

TITANIUM SCAN- ABUTMENT

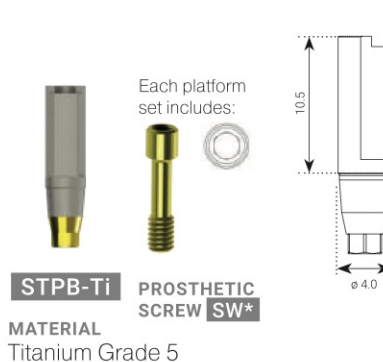

Digital analogs

STANDARD PLATFORM

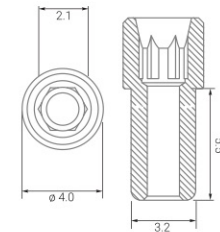

WIDE PLATFORM

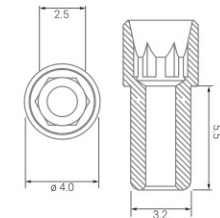

For Multi-units

Scan Abutment
for MU

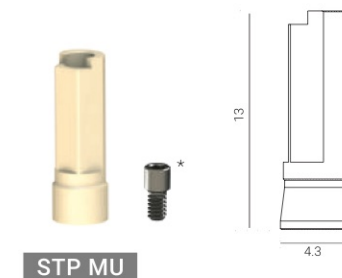

Titanium platform
for CAD/CAM MU

For bridge construction

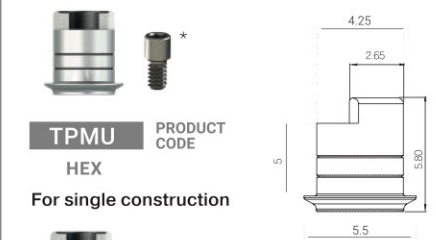

DIGITAL PROTOCOL FOR CREATING AN ORTHOPEDIC STRUCTURE



Home page bio3-implants.com contains the following libraries available for download:
Exocad, Exoplan, 3SHAPE, 3DIEMME, NemoTec, dicomLAB, Blender for dental, ImplaStation

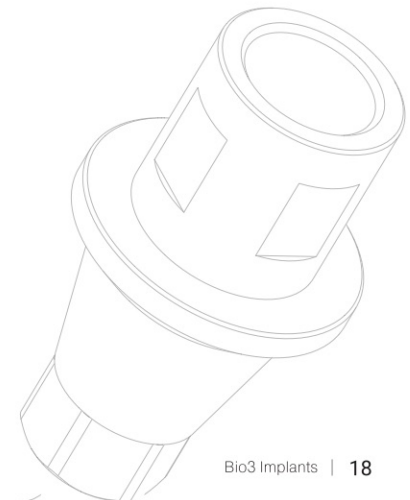
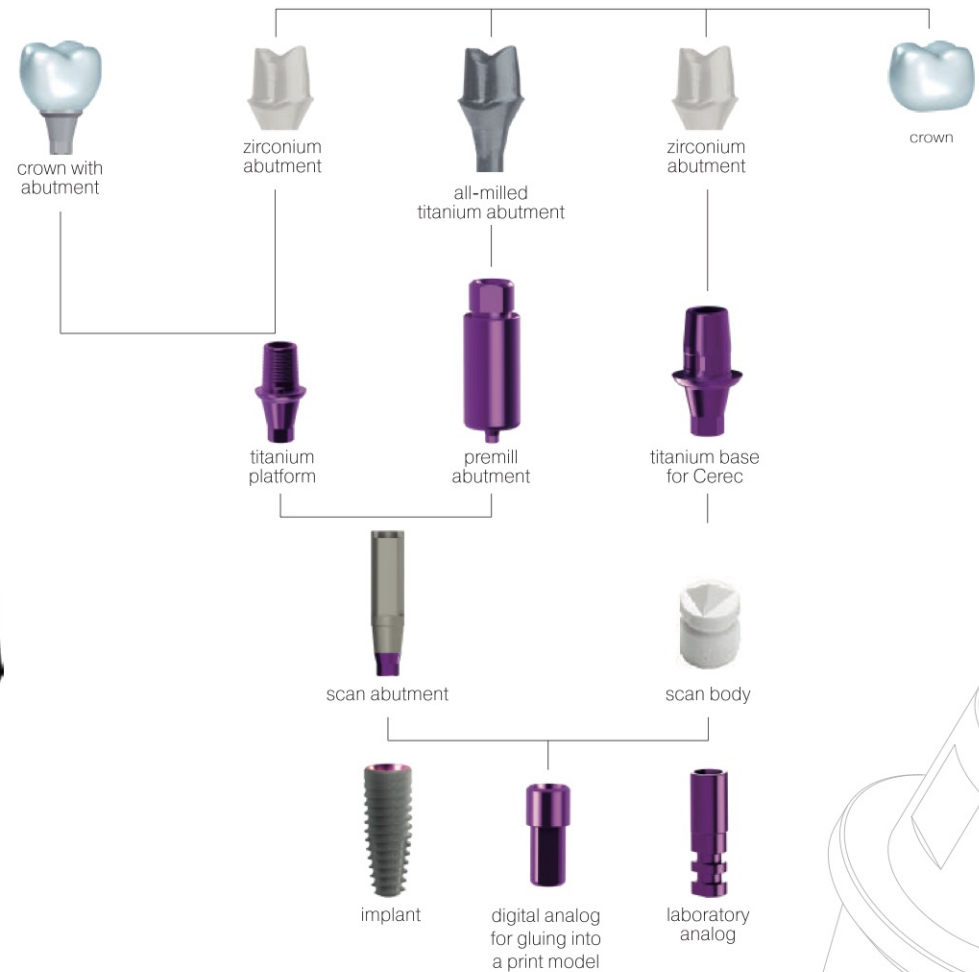

Bio3 IMPLANT SYSTEMS

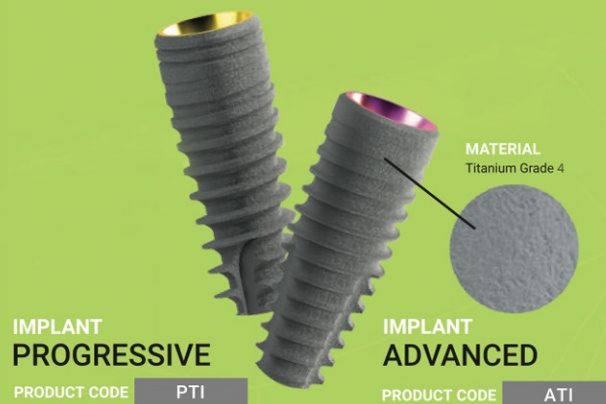

GUIDE SURGICAL KIT



PRODUCT CODE
GSK

Bio3 PENGUIN MONITOR



PRODUCT CODE
55002 Bio3

SURGICAL KIT



PRODUCT CODE
VSC2

 Bio 3 Implants GmbH
Hanauer Str., 8, 75181,
Pforzheim, Germany
+49 723 160 84 104
www.bio3-implants.com
info@bio3-implants.com

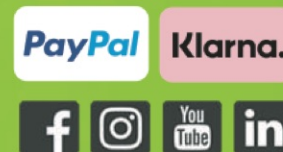

ONLINE SHOP



WEBSITE