

IDENTIFICATION OF PARTS



Figure 1. Handpiece sleeve



Figure 2. Electronic module

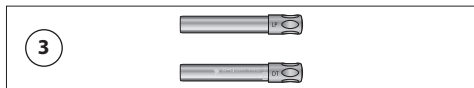

Figure 3. Battery packs (x2)



Figure 4. Light-guide

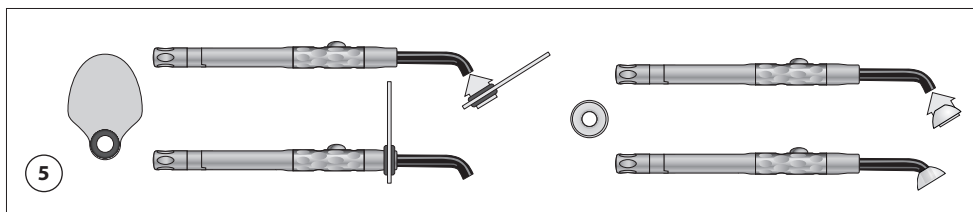

Figure 5. Eye-protection shields

Slide the eye-protection shield (soft or hard version) on the end of the light guide

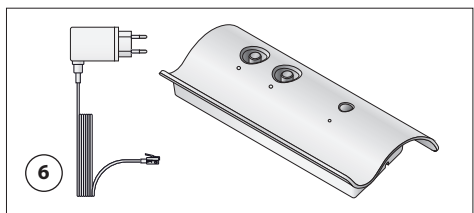

Figure 6. Charging station and power supply

OPERATION

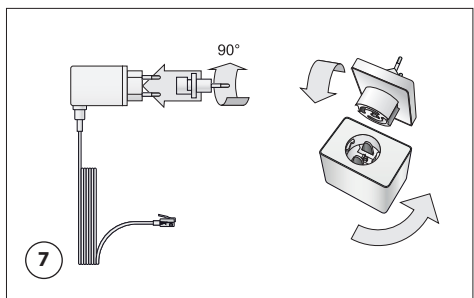

Figure 7. Attaching the plug adapter

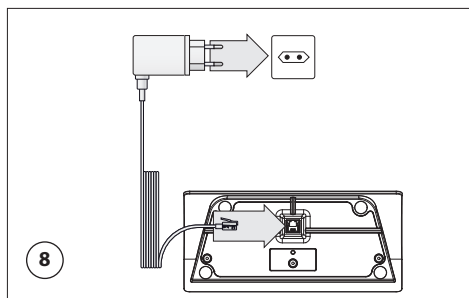

Figure 8. Connecting the charging station

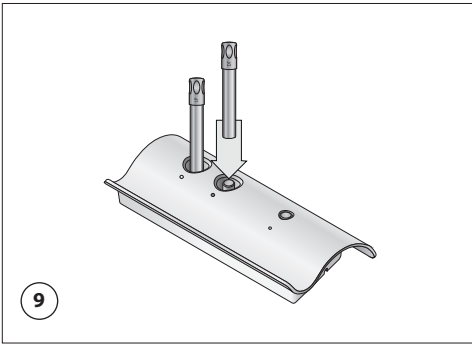

Figure 9. Recharging the battery packs on the charging station

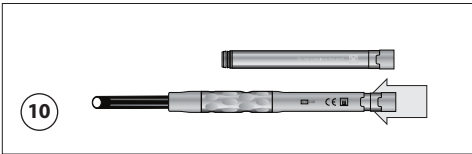

Figure 10. Inserting the electronic module into the hand-piece

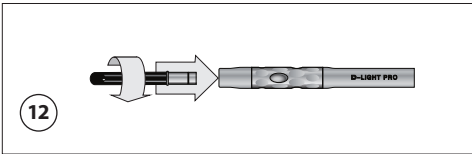

Figure 11. Inserting the battery pack into the handpiece

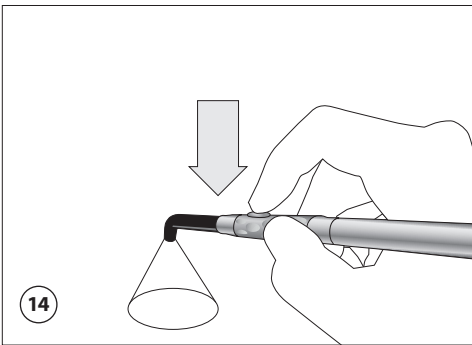

Figure 12. Inserting the light guide into the handpiece
Adjust the light angle; the light guide rotates 360°. Position the light guide tip close to the material for best results. Check the light guide attachment regularly. Check and clean both ends of the light guide.

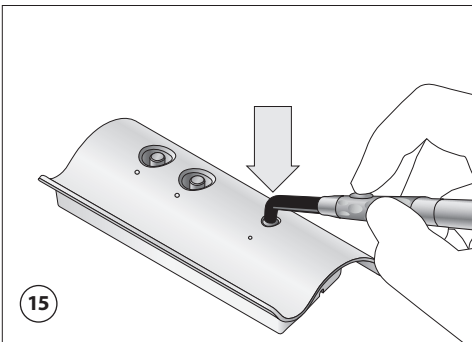

Figure 13. Selecting the curing program
Rotate the battery pack by quarter turns until your desired program faces the reference point.

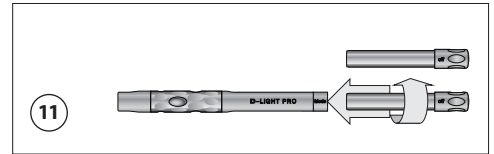

Figure 14. Activating the curing light

Press the switch on the handpiece. The curing light is activated for 20 seconds. After 10 seconds have passed, there will be a quick tone and a flash of the light. At the end of the curing cycle, a tone will sound and the curing light will stop. You can also press the switch to interrupt the curing cycle before its end.

Figure 15. Using the radiometer

Position the light-guide as shown in the illustration and activate the light in High Power mode (HP). A green light indicates sufficient power output, while a red light warns of an insufficient power.

Figure 16. Autoclaving the handpiece sleeve & light-guide

CAUTION! Make sure to remove the electronic module and battery pack before placing the handpiece in the autoclave.

